

**LOS ANGELES COUNTY  
DEPARTMENT OF PUBLIC WORKS**

**BENCH MARK LIST**



**PUENTE QUAD**

**1990 ADJUSTMENT**

## PREFACE 1990

The Department of Public Works' level net is composed of more than 1,700 miles of levels supporting in excess of 9,000 bench marks. In 1990, a major readjustment of the Baseline and nets was undertaken. To emphasize the complete break with previous elevations, the CY, CG & CL series bench marks have been relabeled DY, DG, & DL, respectively.

To facilitate the adjustment, indexing, and distribution of adjusted values of the net, the County territory is divided into 33 quads or areas. For identification purposes each quad is given a name, viz., "Rosemead," "La Mirada," "Santa Fe", etc. When bench marks and elevations in these nets are used, the name of the quad and the date of the adjustment must be included in the bench mark description, e.g.,

DY 9701 - RDBM TAG IN CB 5FT S/O BCR @ SE COR BOLSA ST & DOMINGUEZ ST  
63FT S & 20FT E/O C/L INT  
(GARDENA - 1990) ELEV. 16.704

Experience indicates that this general adjustment will, for the most part, remain sound for the next 10 years. Updating constrained adjustments will be made in 5 years. It is expected that these updating adjustments will be in the nature of a few hundredths of a foot. When a quad is readjusted, new elevation lists will be published and the date of the readjustment will be noted in the bench mark description. Two bench marks with different adjustment dates will not normally agree with each other.

The basic accuracy of the net is reflected by an indicated field probable error of plus or minus 0.012 foot per mile of leveling as determined from over 600 conditions of closure. However, many years experience in vertical control in the greater Los Angeles basin and Antelope Valley indicate that because of varying degrees of subsidence and heaving, the true datum is recovered only by obtaining substantial agreement of a number of bench marks.

The users of this net are invited to assist in its maintenance by notifying this Department of cases of obliteration, apparent mistakes in descriptions or elevations, and proven disturbance of bench marks.

---

DATUM: U.S. Coast and Geodetic Survey Sea Level Datum  
of 1929, through the medium of the Los Angeles  
County Engineer Precise Level Net.

ABBREVIATIONS USED IN BENCH MARK LISTINGS

ABUT -----	Abutment	ECR -----	End of, Curb Return
ALG -----	Along	EC -----	End of Curve
ANG PT -----	Angle Point	ENT -----	Entrance
B/W -----	Back of Walk	FL -----	Floor
BCR -----	Beginning of Curb Return	FTG -----	Footing
BC -----	Beginning of Curve	FRWY -----	Freeway
BLDG -----	Building	F/W -----	Front of Walk
BM -----	Bench Mark	GAR -----	Garage
BT SPK -----	Boat or Bolt Spike	HDWL -----	Headwall
BR CAP -----	Brass or Bronze Cap	HSE -----	House
C B -----	Catch Basin	HWY -----	Highway
CTR -----	Center	INT -----	Intersection
C/L -----	Center Line	IP -----	Iron Pipe
C/L INT -----	Center Line Intersection	LT -----	Left
C/L PROD -----	Center Line Produced	LACE -----	L.A. City Engineer
CONC -----	Concrete	LACS -----	L.A. Co. Engineer
COR -----	Corner	LAFC -----	L.A. Co. Flood Control
COE -----	Corps of Engineers	L&BN -----	Lead and Bench Nail
CULV -----	Culvert	L&BR -----	Lead and Brad
CYN -----	Canyon	L&N -----	Lead and Nail
CB -----	Curb	L&SPK -----	Lead and Spike
CS MON -----	Co. Eng. Monument	L&T -----	Lead and Tack
CT SPK -----	Cut Spike	MCR -----	Middle of Curb Return
DPW -----	Dept. of Public Works	MKD -----	Marked
DR -----	Drive or Driveway	MC -----	Middle of Curve
E/O -----	East of	MON -----	Monument

ABBREVIATIONS USED IN BENCH MARKS (CON'T)

N/O ----- North of  
NR ----- Near  
OPP ----- Opposite  
PI ----- Point of Intersection  
PK&W ----- PK Nail and Washer  
P/L ----- Property Line  
POST ----- Point of Semi-Tangent  
PP ----- Power Pole  
PVMT ----- Pavement  
PROD ----- Produced  
RD ----- Road  
RDBM ----- Road Dept. Bench Mark  
RDBM TAG ----- Road Dept. Bench Mark Tag  
RR ----- Railroad  
RT ----- Right  
R/W ----- Right of Way  
SDMH ----- Storm Drain Manhole  
SMH ----- Sewer Manhole  
SPK ----- Spike  
ST&W ----- Spike Tin and Washer  
S/O ----- South of  
TP ----- Telephone Pole  
USC&GS ----- U.S. Coast and Geodetic Survey  
USGS ----- U.S. Geological Survey  
WK ----- Walk  
W/O ----- West of

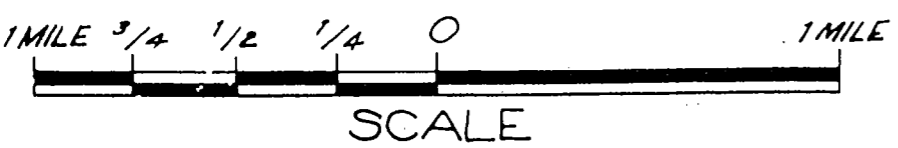
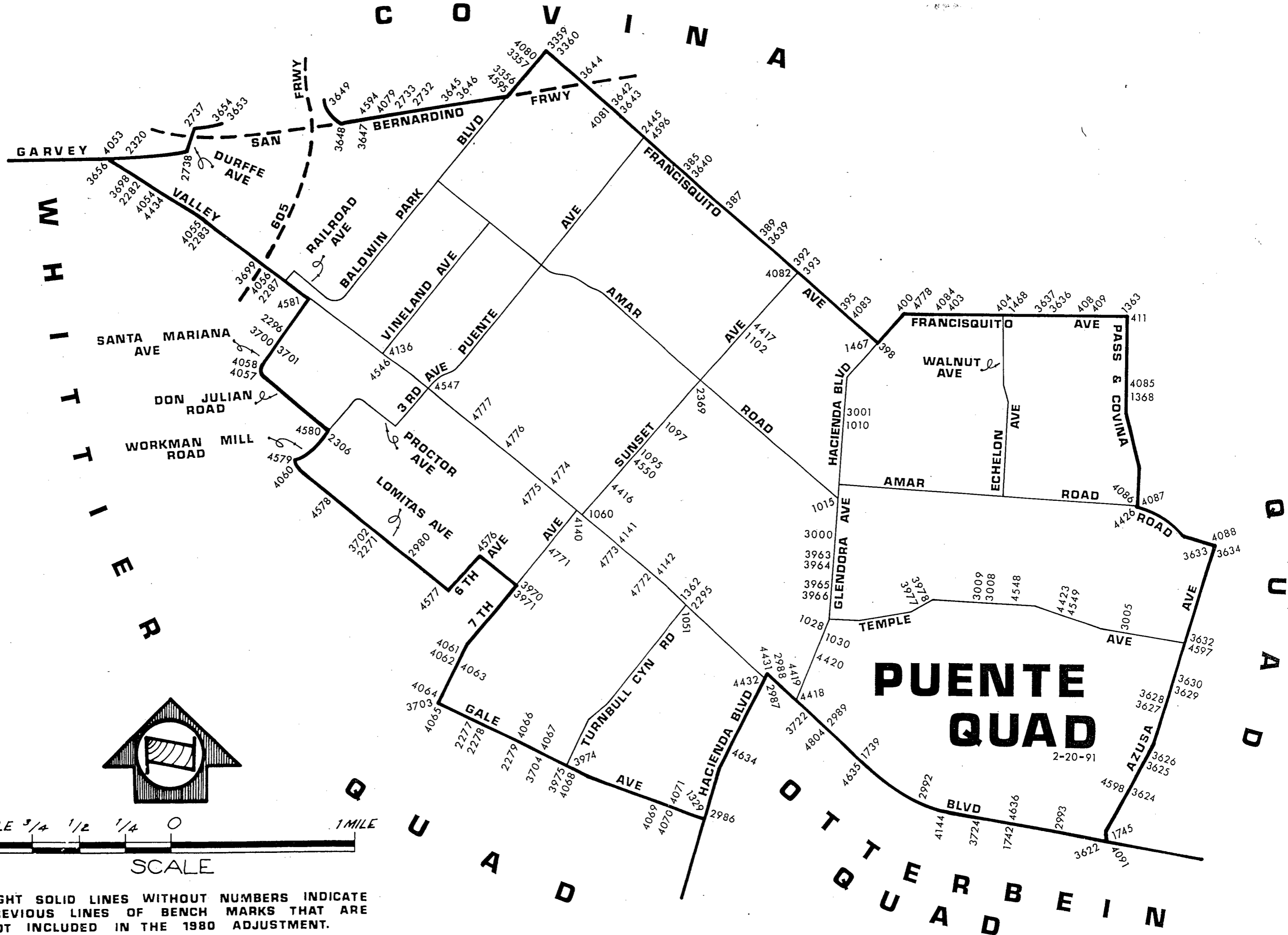

LIGHT SOLID LINES WITHOUT NUMBERS INDICATE PREVIOUS LINES OF BENCH MARKS THAT ARE NOT INCLUDED IN THE 1980 ADJUSTMENT.

QUAD-YEAR	ELEV	DESCRIPTION (INCLUDE QUAD AND YEAR IN DESCRIPTION)	BM NUMBER
BASELINE (1990)	336.303	L&T IN W CB OF WILLOW AVE 1FT N BCR @ NW COR FRANCISQUITO AVE 20FT W & 64FT N C/L INT	DG 385
BASELINE (1990)	337.552	RDBM TAG IN N CB FRANCISQUITO AVE 2FT E BCR @ NE COR RAMA DR 30FT N & 57FT E OF C/L INT	DG 387
BASELINE (1990)	338.531	PK IN E CB ORANGE AVE 2FT S BCR @ SE COR FRANCISQUITO AVE 66FT S & 18FT E C/L INT	DG 389
BASELINE (1990)	341.503	RDBM TAG CB 6FT E C/L PROD N END OF SERVICE RD 50FT S C/L FRANCISQUITO AVE & 55FT W C/L SUNSET AVE	DG 392
BASELINE (1990)	341.599	L&BRAD 6FT E BCR 30FT S C/L FRANCISQUITO AVE & 80FT E C/L SUNSET AVE	DG 393
BASELINE (1990)	343.238	L&BRAD 3FT E OF CATCH BASIN 30FT S C/L FRANCISQUITO AVE & 55FT W C/L CALIFORNIA AVE	DG 395
BASELINE (1990)	345.348	RDBM TAG IN CB 75FT S C/L FRANCISQUITO AVE TO W & 30FT E/O C/L HACIENDA BLVD	DG 398
BASELINE (1990)	354.120	LACS MON @ C/L INT FRANCISQUITO AVE TO THE E & HACIENDA BLVD MKD (PUENTE G-6A 1953)	DG 400
BASELINE (1990)	363.171	L&N @ SE COR MULLENDER AVE (WLY INT) & FRANCISQUITO AVE 18FT E & 45FT S/O C/L INT	DG 403
BASELINE (1990)	371.983	SQ HD SPK IN N CB 1FT W/O C B @ NE COR FRANCISQUITO AVE & WALNUT AVE 18FT N & 40FT E C/L INT MKD (AZ 202)	DG 404
BASELINE (1990)	407.162	L&BN S CB 10FT E BCR 20FT S & 55FT E C/L INT PASS & COVINA RD & FRANCISQUITO AVE	DG 411
PUENTE (1990)	333.884	L&T CONC CB 0.5FT N BCR 50FT N & 40FT E C/L INT HACIENDA BLVD & FAIRGROVE AVE TO THE E	DG 1010
PUENTE (1990)	326.345	L&T E CB 2FT S/O N END C B C/L PROD ELLIOTT AVE 40FT E/O C/L HACIENDA BLVD	DG 1015
PUENTE (1990)	352.429	L&T W EDGE CONC WK TO HSE NO 15700 VICTORIA AVE 32FT S C/L & 42FT E C/L GLENDORA AVE	DG 1028
PUENTE (1990)	355.230	L&T N END 1ST STEP TO W ENT METHODIST CHURCH 30FT E/O C/L GLENDORA AVE & 125FT N C/L HILL ST	DG 1030
PUENTE (1990)	309.869	L&BN CTR CONC WALL IN CTR OF BRICK BLDG NO 15222 65FT S C/L VALLEY BLVD 275FT E C/L TURNBULL CYN RD	DG 1051

QUAD-YEAR	ELEV	DESCRIPTION (INCLUDE QUAD AND YEAR IN DESCRIPTION)	BM NUMBER
PUENTE (1990)	302.642	L&BN WINGWALL TO SPRR BRIDGE 70FT N C/L VALLEY BLVD & 65FT E C/L SUNSET AVE 10FT S OF S RAIL	DG 1060
PUENTE (1990)	310.819	L&T N EDGE OF 1ST STEP FRONT OF HSE NO 556 @ SE COR SUNSET AVE & TEMPLE AVE 68FT S & 64FT E/O C/L INT	DG 1095
PUENTE (1990)	311.150	RDBM TAG E CB SUNSET AVE W SIDE OF ISL 40FT E C/L 15FT N C/L PROD HUTCHCROFT ST TO E	DG 1097
PUENTE (1990)	327.811	RDBM TAG E CB 6FT S BCR @ SE COR SUNSET AVE & FAIRGROVE AVE 66FT S & 40FT E C/L INT	DG 1102
BASELINE (1990)	332.144	RDBM TAG N CB 9FT E BCR @ NW COR HACIENDA BLVD & GALE AVE 36FT N & 70FT W C/L INT	DG 1329
PUENTE (1990)	308.039	L&T N CB VALLEY BLVD C/L PROD TURNBULL CANYON RD 1FT W OF E EDGE CATCH BASIN	DG 1362
BASELINE (1990)	405.298	CS MON IN WELL @ C/L INT PASS & COVINA RD & FRANCISQUITO AVE (USE S EDGE)	DG 1363
BASELINE (1990)	428.275	L&BN S CB 2FT E BCR @ SE COR MAPLEGROVE ST & PASS & COVINA RD 20FT S & 45FT E C/L INT	DG 1368
BASELINE (1990)	345.515	CS MON C/L INT FRANCISQUITO AVE TO W & HACIENDA BLVD	DG 1467
BASELINE (1990)	370.404	CS MON 6FT E & 1FT N C/L INT FRANCISQUITO AVE & WALNUT AVE MKD (PUENTE I-6 1953)	DG 1468
BASELINE (1990)	343.593	RDBM TAG N CB 4FT E/O BC OF CB 20FT N/O C/L OLD VALLEY BLVD & 420FT E/O C/L VALLEY BLVD OVERPASS	DG 1739
BASELINE (1990)	379.459	RD MON IN WELL 7IN DN @ C/L INT VALLEY BLVD & AZUSA WAY	DG 1745
BASELINE (1990)	372.966	CS MON IN WELL 10IN DN @ C/L INT LOMITAS AVE & 4TH AVE MKD (PUENTE A8)	DG 2271
BASELINE (1990)	351.134	L&T W CB OF W SERV RD 2FT S BCR @ SW COR GALE AVE & LATCHFORD AVE 15FT W & 44FT S C/L INT S SERV RD	DG 2277
BASELINE (1990)	350.840	L&T N CB OF S SERV RD @ SE COR GALE AVE & LATCHFORD AVE 14FT N & 36FT E C/L INT SERV RD	DG 2278
BASELINE (1990)	331.512	CS MON IN WELL 10IN DN @ C/L INT GALE AVE & 9TH AVE MKD (PUENTE C-11)	DG 2279
BASELINE (1990)	289.404	RDBM TAG IN E CB ALLGEYER AVE 1FT S BCR @ SE COR VALLEY BLVD 20FT E & 67FT S C/L INT	DG 2282

QUAD-YEAR	ELEV	DESCRIPTION (INCLUDE QUAD AND YEAR IN DESCRIPTION)	BM NUMBER
BASELINE (1990)	288.049	CS MON IN WELL 12IN DN 6FT N & 75FT W C/L INT VALLEY BLVD & RUMFORD AVE MKD (EL MONTE K-5B 1940)	DG 2283
BASELINE (1990)	291.446	CS MON IN WELL 12IN DN 15FT S OF N EDGE OF CONC PVMT VALLEY BLVD & 230FT W C/L SAN ANGELO AVE MKD (L-6 RE 2177)	DG 2287
PUENTE (1990)	306.815	LACS MON IN WELL 10IN DN 16FT N C/L VALLEY BLVD ON C/L PROD TURNBULL CYN RD 4FT S/O N CB MKD (PUENTE E-9A 1956)	DG 2295
BASELINE (1990)	290.653	L&T N END 1ST CONC STEP OF HSE NO 137 50FT W C/L SANTA MARIANA AVE 0.05MI S/O C/L VALLEY BLVD	DG 2296
BASELINE (1990)	300.906	L&T 5FT FROM END CONC WK TO HSE NO 13561 DON JULIAN RD 75FT W/O C/L WORKMAN MILL RD & 50FT N/O C/L DON JULIAN RD	DG 2306
BASELINE (1990)	290.207	RDBM TAG S CB 30FT S C/L GARVEY AVE @ ENT TO UNDERPASS OF RR 450FT E VALLEY BLVD OPP SE COR BOWLING ALLEY COFFEE SHOP	DG 2320
PUENTE (1990)	317.894	RDBM TAG IN CB 1FT S BCR 70FT S & 40FT E C/L INT SUNSET AVE & AMAR RD	DG 2369
BASELINE (1990)	334.673	RDBM TAG N CB 36FT W BCR 113FT W & 30FT N C/L INT FRANCISQUITO AVE & PUENTE AVE	DG 2445
BASELINE (1990)	310.851	RDBM TAG IN N CB 1FT W END OF CB TO RICHFIELD GAS STA @ NW COR FRAZIER ST & GARVEY AVE 65FT W & 20FT N C/L INT 175FT E/O C/L BESS AVE	DG 2732
BASELINE (1990)	310.106	RDBM TAG IN E CB 1FT FROM BCR @ NE COR GARVEY AVE & BESS AVE 35FT N & 20FT E C/L INT	DG 2733
BASELINE (1990)	297.431	L&N W CB 1FT N BCR @ NW COR EXLINE ST & DURFEE AVE 37FT N & 45FT W C/L INT	DG 2737
BASELINE (1990)	296.447	RDBM TAG N CB 1FT E/O BCR @ NW COR DURFEE AVE & GARVEY AVE 37FT W & 30FT N C/L INT	DG 2738
BASELINE (1990)	287.318	RD HD SPK N CB 9FT W/O BCR 20FT N/O C/L LOMITAS AVE & 50FT W/O C/L 5TH AVE MKD (AZ 490)	DG 2980
BASELINE (1990)	332.908	CS MON FL IN C B ON SE COR HACIENDA BLVD & GALE AVE 22FT E/O BCR 42FT S & 105FT E/O C/L INT MKD (BM 38-13A 1963)	DG 2986
BASELINE (1990)	318.576	L&BN E CB 5FT N BCR @ SE COR VALLEY BLVD & HACIENDA BLVD 41FT E & 71FT S C/L INT MKD (BM)	DG 2987



QUAD-YEAR	ELEV	DESCRIPTION (INCLUDE QUAD AND YEAR IN DESCRIPTION)	BM NUMBER
BASELINE (1990)	318.254	RDBM TAG N CB 57FT E BCR @ NE COR VALLEY BLVD & HACIENDA BLVD 40FT N & 120FT E C/L INT	DG 2988
BASELINE (1990)	334.724	RDBM TAG W CB 1FT N BCR @ NW COR OLD VALLEY BLVD & ALBERT ST 46FT N & 18FT W C/L INT	DG 2989
BASELINE (1990)	353.949	RDBM TAG N CB NR W END C B 25FT N APPROX C/L N BARREL VALLEY BLVD NR INT OLD VALLEY BLVD 0.2MI W C/L FERRERO LN	DG 2992
BASELINE (1990)	376.376	RDBM TAG N CB VALLEY BLVD 40FT N C/L @ E END C B 175FT W/O APPROX C/L PROD ANAHEIM -PUENTE RD	DG 2993
PUENTE (1990)	326.083	CS MON FL IN C B ON W SIDE HACIENDA BLVD & 3FT S OF S CB PROD LOUKELTON ST MKD (BM 38-16A 1963)	DG 3000
PUENTE (1990)	334.029	CS MON FL SW COR C B ON NELY COR HACIENDA BLVD & FAIRGROVE AVE 75FT NLY & 42FT ELY APPROX C/L INT MKD (BM 38-17A 1963)	DG 3001
PUENTE (1990)	390.118	L&SPK N CB 6FT E BCR @ NE COR TEMPLE AVE & MANGATE AVE 30FT N & 69FT E/O C/L INT MKD ( BM )	DG 3005
PUENTE (1990)	397.550	L&SPK E CB 5FT N BCR @ NE COR TEMPLE AVE & GREYCLIFF AVE 50FT S/O C/L SERVICE RD MKD (BM)	DG 3008
PUENTE (1990)	399.694	L&SPK W CB 9FT N BCR @ NW COR TEMPLE AVE & LANNY AVE SERVICE RD 102FT S/O C/L CAMBAY ST MKD (BM)	DG 3009
BASELINE (1990)	321.855	RDBM TAG 2FT E LY BCR 20FT S LY & 47FT E LY C/L INT GARVEY AVE & WACO ST	DG 3356
BASELINE (1990)	325.234	RDBM TAG 2FT S LY BCR 20FT E LY & 46FT S LY C/L INT GARVEY AVE & TRACY ST	DG 3357
BASELINE (1990)	329.910	RDBM TAG 10FT N LY BCR 58FT S LY & 41.5FT W LY C/L INT BALDWIN PARK BLVD & FRANCISQUITO AVE (10FT N/O BCR)	DG 3359
BASELINE (1990)	330.425	RDBM TAG 10FT S LY BCR 60FT N LY & 40FT E LY C/L INT BALDWIN PARK BLVD & FRANCISQUITO AVE	DG 3360
BASELINE (1990)	379.903	L & BN @ NE COR FTG OF RR SIGNAL 80FT S & 125FT W C/L INT VALLEY BLVD & AZUSA AVE	DG 3622
BASELINE (1990)	395.962	RDBM TAG 1FT E BCR 18FT S & 90FT E C/L INT AZUSA AVE & SALAIS ST	DG 3624
BASELINE (1990)	432.723	L & T IN CHIS SQ 1FT S BCR 51FT S & 45FT E C/L INT AZUSA AVE & RENAULT ST	DG 3625

QUAD-YEAR	ELEV	DESCRIPTION (INCLUDE QUAD AND YEAR IN DESCRIPTION)	BM NUMBER
BASELINE (1990)	433.839	L & BN 1FT N BCR 58FT N & 14FT E C/L INT AZUSA AVE SERVICE RD & RENAULT ST	DG 3626
BASELINE (1990)	449.051	L & T 1FT S BCR 45FT S & 14FT E C/L INT AZUSA AVE SERVICE RD & GEMINI ST	DG 3627
BASELINE (1990)	450.162	L & BN 1FT S BCR 52FT N & 45FT E C/L INT AZUSA AVE & GEMINI ST	DG 3628
BASELINE (1990)	440.446	CITY OF INDUSTRY MON FL 6FT S BCR 66FT S & 45FT E C/L INT AZUSA AVE & GLENLOCH LN MKD (BENCH MARK PASS COVINA SIX)	DG 3629
BASELINE (1990)	438.411	RDBM TAG 1FT N BCR 70FT N & 45FT E C/L INT AZUSA AVE & GLENLOCH LN	DG 3630
BASELINE (1990)	400.026	L & T 1FT S BCR 68FT N & 45FT W C/L INT AZUSA AVE & TEMPLE AVE	DG 3632
BASELINE (1990)	444.493	L & T 4FT S BCR 78FT S & 45FT W C/L INT AZUSA AVE & AMAR RD	DG 3633
BASELINE (1990)	444.215	RDBM TAG 1FT S BCR 90FT S & 45FT E C/L INT AZUSA AVE & AMAR RD	DG 3634
BASELINE (1990)	382.856	RDBM TAG 5FT E BCR 20FT S & 51FT E C/L INT FRANCISQUITO AVE & INDIAN SUMMER AVE	DG 3636
BASELINE (1990)	382.384	RDBM TAG 3FT S BCR 49FT S & 18FT W C/L INT FRANCISQUITO AVE & INDIAN SUMMER AVE	DG 3637
BASELINE (1990)	339.236	LACS BR MON FL IN WALK 1FT BACK OF CB 30FT N & 45FT E C/L INT FRANCISQUITO AVE & ORANGE AVE MKD (BM 37-12B 1963)	DG 3639
BASELINE (1990)	336.560	LACS BR MON FL IN WALK 1FT BACK OF CB 32FT N & 40FT W C/L INT FRANCISQUITO AVE & WILLOW AVE MKD (BM 37-13B 1963)	DG 3640
BASELINE (1990)	338.469	LACS MON FL IN NE ABUT OF BRIDGE OVER WALNUT CREEK 32FT N & 220FT W C/L INT FRANCISQUITO AVE & DUNDRY AVE MKD (BM 37-15A 1963)	DG 3642
BASELINE (1990)	334.510	RDBM TAG 5FT E/O BCR 50FT N LY & 55FT W LY C/L INT FRANCISQUITO AVE & DALEWOOD AVE	DG 3643
BASELINE (1990)	332.913	RAMSET 6FT W BCR 30FT N & 63FT W C/L INT PADDY LN & FRANCISQUITO AVE	DG 3644
BASELINE (1990)	318.723	PK IN S CB 15FT S & 50FT W C/L INT GARVEY AVE & FAIRGROVE ST	DG 3645

QUAD-YEAR	ELEV	DESCRIPTION (INCLUDE QUAD AND YEAR IN DESCRIPTION)	BM NUMBER
BASELINE (1990)	317.323	RDBM TAG 5FT W BCR 20FT N & 95FT W C/L INT GARVEY AVE & FAIRGROVE ST	DG 3646
BASELINE (1990)	302.315	L & BR IN S CB 15FT S & 55FT E LY C/L INT GARVEY AVE & WESTCOTT AVE	DG 3647
BASELINE (1990)	298.240	RDBM TAG IN S END C B 40FT N & 20FT E LY C/L INT GARVEY AVE & SYRACUSE AVE	DG 3648
BASELINE (1990)	298.992	RDBM TAG IN CB 5FT S C B 20FT W LY C/L SYRACUSE AVE & 75FT N LY C/L PROD OF GARVEY AVE	DG 3649
BASELINE (1990)	299.813	RDBM TAG IN S CB 20FT S & 25FT E C/L INT EXLINE ST & GILMAN RD	DG 3653
BASELINE (1990)	299.881	RDBM TAG 3FT N BCR 30FT N & 22FT W C/L INT EXLINE ST & GILMAN RD	DG 3654
BASELINE (1990)	288.572	WASHER & BN 3FT W/O BCR 30FT S & 50FT W/O C/L INT GARVEY AVE & VALLEY BLVD MKD (ME-22)	DG 3656
BASELINE (1990)	289.485	L & BR 1FT W BCR 40FT S & 62FT W C/L INT VALLEY BLVD & ALLGEYER AVE	DG 3698
BASELINE (1990)	298.707	L AFC MON FL IN E ABUT OF BRDG OVER SAN GABRIEL RIVER 45FT S C/L VALLEY BLVD 57FT W/O W LY ON RAMP 605 FWY MKD (BM 78-34A)	DG 3699
BASELINE (1990)	284.400	LACS MON IN WELL 8IN DN @ C/L SAN ANGELO AVE & PROCTOR AVE MKD ( RE 7078)	DG 3700
BASELINE (1990)	284.843	L & T IN NE COR WK 55FT S & 31FT W C/L INT SAN ANGELO AVE & PROCTOR AVE	DG 3701
BASELINE (1990)	371.730	RDBM TAG 3FT S/O BCR 50FT S/O C/L LOMITAS AVE & 20FT E/O C/L 4TH AVE	DG 3702
BASELINE (1990)	358.370	RDBM TAG @ W END CUL DE SAC SERVICE RD 71FT N/O C/L GALE AVE & 73FT E/O C/L 7TH AVE (CTR CUL-DE- SAC)	DG 3703
BASELINE (1990)	326.586	RDBM TAG 2FT S BCR 58FT S & 18FT E C/L INT GALE AVE & VALENCIA AVE	DG 3704
BASELINE (1990)	331.822	USGS MON FL IN VERT WALL @ NW COR BLDG 30FT S OLD VALLEY BLVD & 5FT W C/L PROD 1ST ST MKD (331)	DG 3722
BASELINE (1990)	362.497	LACS CONTROL SYS MON FL IN CTR CONC HDWL 64FT S C/L S BBL VALLEY BLVD & 390FT E C/L FERRERO LN 10FT N/O N RAIL SPRR MKD (H-11 RM NO 1 1958)	DG 3724

QUAD-YEAR	ELEV	DESCRIPTION (INCLUDE QUAD AND YEAR IN DESCRIPTION)	BM NUMBER
PUENTE (1990)	334.076	L & BN IN CB 32FT W C/L GLENDORA AVE & 10FT N C/L PROD SIERRA VISTA CT	DG 3963
PUENTE (1990)	333.855	L & BN IN CB 22FT E BCR 20FT N & 79FT E C/L INT GLENDORA AVE & SIERRA VISTA CT	DG 3964
PUENTE (1990)	337.422	L & BN IN CHIS SQ IN CB 16FT S & 84FT E C/L INT GLENDORA AVE & MONTANA AVE 28FT E/O BCR	DG 3965
PUENTE (1990)	346.706	L & T IN C B 7FT S BCR 70FT S & 31FT E C/L INT GLENDORA AVE & TEMPLE AVE	DG 3966
BASELINE (1990)	292.153	RDBM TAG IN CB 2FT N/O BCR 60FT N/O C/L DON JULIAN RD & 25FT W/O C/L 7TH AVE	DG 3970
BASELINE (1990)	292.225	CITY OF INDUSTRY MON FL 2FT E/O BCR 20FT N/O C/L DON JULIAN RD & 63FT E/O C/L 7TH AVE MKD (DJ 5) (MKD DJ5)	DG 3971
BASELINE (1990)	325.247	L & PK 33FT E BCR 32FT N & 115FT E C/L INT GALE AVE & TURNBULL CYN RD	DG 3974
BASELINE (1990)	326.030	RDBM TAG 35FT W BCR 32FT S & 97FT W C/L INT GALE AVE & TURNBULL CYN RD	DG 3975
PUENTE (1990)	394.074	L & T 12FT W BCR 32FT N & 54FT W C/L INT TEMPLE AVE DEL VALLE AVE	DG 3977
PUENTE (1990)	396.554	L & T 12FT E BCR 32FT S & 53FT E C/L INT TEMPLE AVE & DEL VALLE AVE	DG 3978
BASELINE (1990)	288.644	CSBM MON IN C B 1FT N/O NORTH CB GARVEY AVE 44 FT N/O C/L GARVEY AVE & 86FT W/O C/L COGSWELL RD MKD ( BM-12-5A-1971)	DG 4053
BASELINE (1990)	291.533	RDBM TAG IN W CB 75FT W/O C/L DURFEE AVE 80FT S/O C/L VALLEY BLVD	DG 4054
BASELINE (1990)	288.596	CSBM MON IN C B 37FT N/O C/L VALLEY BLVD & 213FT E/O C/L RUMFORD AVE MKD ( BM-12-4B 1971)	DG 4055
BASELINE (1990)	291.257	CSBM MON IN WELL 2FT W/O WEST CB 22FT W/O C/L SAN ANGELO AVE & 230FT S/O C/L VALLEY BLVD MKD ( BM 12-3A 1971)	DG 4056
BASELINE (1990)	277.133	L&T IN CONC CB 20FT S/O C/L DON JULIAN RD & 13FT W/O C/L FLOOD CONTROL CHANNEL 370FT E/O C/L SAN ANGELO AVE TO THE S	DG 4057
BASELINE (1990)	277.146	RDBM TAG IN W WALL C B 20FT N/O C/L DON JULIAN RD & 38FT E/O C/L FLOOD CONTROL CHANNEL 465FT E/O C/L SAN ANGELO AVE TO THE S	DG 4058

QUAD-YEAR	ELEV	DESCRIPTION (INCLUDE QUAD AND YEAR IN DESCRIPTION)	BM NUMBER
BASELINE (1990)	340.815	L&T IN N CB LOMITAS AVE 20FT N/O C/L LOMITAS AVE & 102FT W/O C/L WORKMAN MILL RD	DG 4060
BASELINE (1990)	320.094	L&T IN CB RET 43FT W/O C/L 7TH AVE & 50FT N/O C/L CLARK AVE 9FT S/O BCR	DG 4061
BASELINE (1990)	322.556	L&T IN W CB 1FT S/O BCR 42FT W/O C/L 7TH AVE & 46FT S/O C/L CLARK AVE	DG 4062
BASELINE (1990)	325.223	CSBM MON IN N WALL C B 2FT W/O WEST CB 42FT W/O C/L 7TH AVE & 158 FT S/O C/L CLARK AVE MKD ( BM 42-3C 1971)	DG 4063
BASELINE (1990)	355.913	RDBM TAG IN WEST CB IN S WALL BOX CULVERT 42FT W/O C/L 7TH AVE & 137 FT N/O C/L GALE AVE	DG 4064
BASELINE (1990)	361.843	CSBM MON FL IN N WALL C B 1FT E/O EAST CURB 44 FT E/O C/L 7TH AVE & 65FT S/O C/L GALE AVE MKD ( BM 42-4A 1971)	DG 4065
BASELINE (1990)	332.689	CSBM MON FL 1FT N/O NORTH CB IN E WALL C B 31FT N/O C/L GALE AVE & 50FT W/O C/L 9TH AVE MKD ( BM 42-5-B 1971)	DG 4066
BASELINE (1990)	325.494	L&T IN CTR CB RET 38FT N/O GALE AVE & 26FT E/O C/L VALENCIA AVE	DG 4067
BASELINE (1990)	325.837	CSBM 1FT W/O WEST CB IN S WALL C B 34FT W/O C/L TURNBULL CYN RD & 60FT S/O C/L GALE AVE MKD ( BM 42- 5C 1971)	DG 4068
BASELINE (1990)	327.426	CSBM MON 1FT S/O SOUTH CB IN E WALL C B 33FT S/O C/L GALE AVE & 105FT E/O C/L KWIS AVE MKD ( BM 42-6A 1971)	DG 4069
BASELINE (1990)	329.420	RDBM TAG IN CONC WK 3FT S/O S CB 8FT W/O C/L FLOOD CONTROL CHANNEL BRDG NO B1659 35FT S/O C/L GALE AVE & 240FT W/O C/L FARMSTEAD AVE	DG 4070
BASELINE (1990)	328.635	L&T IN CONC WK 1.5FT N/O N CB 8FT E/O C/L FC CHANNEL BRDG NO B1659 34FT N/O C/L GALE AVE & 225FT W/O FARMSTEAD AVE	DG 4071
BASELINE (1990)	305.375	CS BM MON IN WELL 1FT BACK OF CB 21FT N/O C/L GARVEY AVE & 615FT W/O C/L BESS AVE 20FT W/O SW COR BLDG NO 12953 MKD (BM 37-18A 1971)	DG 4079
BASELINE (1990)	325.106	CSBM MON FL IN SOUTH CB 20FT S/O C/L TRACY ST & 74FT W/O C/L BALDWIN PARK BLVD MKD (BM 37-16A 1966)	DG 4080

QUAD-YEAR	ELEV	DESCRIPTION (INCLUDE QUAD AND YEAR IN DESCRIPTION)	BM NUMBER
BASELINE (1990)	339.005	L AFC MON FL IN NW ABUT BRDG OVER WALNUT CREEK 32FT N/O FRANCISQUITO AVE & 334FT W/O DUNDRY AVE MKD (BM 080-00020-1964)	DG 4081
BASELINE (1990)	340.988	CSBM MON IN WELL 1FT BK CB 5FT N/O BCR 42FT W/O C/L SUNSET AVE & 61FT S/O C/L FRANCISQUITO AVE MKD ( 37-11B 1971)	DG 4082
BASELINE (1990)	343.308	L&SPK IN CONC CB 51FT E/O C/L CALIFORNIA AVE & 33FT S/O C/L FRANCISQUITO AVE 6FT E/O BCR	DG 4083
BASELINE (1990)	362.575	SPK 7FT W/O BCR @ SW COR FRANCISQUITO AVE & MULLENDER AVE 19FT S & 53FT W C/L INT MKD (AZ 26)	DG 4084
BASELINE (1990)	428.379	CSBM MON IN W WALL OF C B @ NE COR MAPLEGROVE ST & PASS & COVINA RD 20FT N & 59FT E C/L INT MKD (BM 37-5A 1971)	DG 4085
BASELINE (1990)	407.832	CSBM MON FL IN SLY WALL OF C B 5FT N/O BCR @ NW COR LARK ELLEN AVE & AMAR RD 33FT W & 87FT N C/L INT MKD (BM 37-4B 1971)	DG 4086
BASELINE (1990)	409.197	RAMSET NR CTR CB RET @ NE COR LARK ELLEN AVE & AMAR RD 36FT E & 55FT N C/L INT	DG 4087
BASELINE (1990)	445.994	CSBM FL IN W WALL C B @ NW COR AMAR RD & AZUSA AVE 35FT W/O BCR 130FT W & 46FT N C/L INT MKD (BM 37-3A 1971)	DG 4088
BASELINE (1990)	379.333	CS MON @ E END CONC HDWL 62FT S C/L VALLEY BLVD & 124FT E C/L PROD AZUSA WAY 10FT N/O SPRR RAILS MKD (BM 11-106B 1971)	DG 4091
PUENTE (1990)	294.078	LACS BM MON FL IN CONC HDWL 31FT E C/L VINELAND AVE & 22FT S C/L PROD PITCHESS PL 130FT N C/L VALLEY BLVD MKD (BM 12-1A 1971)	DG 4136
PUENTE (1990)	300.939	L&T CTR OF CB RET 49FT S/O C/L VALLEY BLVD & 49 FT E/O C/L 7TH AVE	DG 4140
PUENTE (1990)	302.311	LACS MON IN WELL 4FT S/O N CB VALLEY BLVD ON C/L PROD 8TH AVE 20FT N EXIST C/L MKD (PUENTE D-9C 1956)	DG 4141
PUENTE (1990)	303.688	LACS MON IN WELL 4FT S/O N CB VALLEY BLVD ON C/L PROD 9TH AVE 21FT N EXIST C/L MKD (PUENTE D-9B 1956)	DG 4142
BASELINE (1990)	357.552	L&BN E END CONC HDWL 88FT S C/L VALLEY BLVD 0.1MI W C/L FERRERO LN 5FT N/O N RAIL SPRR NR INT OF OLD VALLEY BLVD	DG 4144

QUAD-YEAR	ELEV	DESCRIPTION (INCLUDE QUAD AND YEAR IN DESCRIPTION)	BM	NUMBER
PUENTE (1990)	304.053	L&T MCR MEDIAN CB 5FT E/O C/L SUNSET AVE & 35FT N/O C/L NELSON AVE	DG	4416
PUENTE (1990)	328.355	LACO FC TAG IN E CB SUNSET AVE 40FT E/O C/L SUNSET AVE & 61FT N/O C/L FAIRGROVE AVE 6FT N/O BCR	DG	4417
BASELINE (1990)	330.119	RCE TAG NO 5828 IN CB 3FT N/O BCR @ NE COR MAIN ST & GLENDORA AVE 51FT N & 44FT E/O C/L INT	DG	4418
BASELINE (1990)	328.986	RDBM TAG IN CB 1FT N/O BCR @ NW COR STAFFORD ST & GLENDORA AVE 85FT N & 30FT W/O C/L INT	DG	4419
PUENTE (1990)	343.696	L&T IN W CB GLENDORA AVE 30FT W/O C/L ON C/L PROD LAS VACINAS DR	DG	4420
PUENTE (1990)	402.772	L&RCE TAG NO 5828 1FT N/O BCR @ NW COR TEMPLE AVE & VALINDA AVE 71FT N & 32FT W/O C/L INT	DG	4423
BASELINE (1990)	409.249	CITY OF COVINA BR CAP MON IN CB 37FT N/O BCR @ NE COR AMAR RD & LARK ELLEN AVE 110FT N & 32FT E/O C/L INT MKD ( BM NO 100)	DG	4426
BASELINE (1990)	321.489	RDBM TAG IN E CB 1FT S/O BCR @ SE COR STAFFORD ST & HACIENDA BLVD 112FT S & 46FT E/O C/L INT	DG	4431
BASELINE (1990)	321.865	RDBM TAG IN S CB 1FT W/O BCR @ SW COR STAFFORD ST & HACIENDA BLVD 58FT W & 46FT S/O C/L INT	DG	4432
BASELINE (1990)	291.972	RDBM TAG IN CB 2FT S/O BCR 82FT S/O C/L VALLEY BLVD & 42FT E/O C/L DURFEE AVE	DG	4434
PUENTE (1990)	292.298	L&T CONC CB 13FT W/O BCR 40FT S/O C/L VALLEY BLVD & 60FT W/O C/L 2ND AVE	DG	4546
PUENTE (1990)	295.418	RDBM TAG 1FT W/O BCR 42FT S/O C/L VALLEY BLVD & 89FT W/O C/L 3RD AVE	DG	4547
PUENTE (1990)	407.082	1-1/4IN BR DISC IN E CB 3FT N BCR 71FT N/O C/L TEMPLE AVE & 18FT E/O C/L RUTHCREST AVE	DG	4548
PUENTE (1990)	402.768	RCE TAG NO.5828 IN E CB 1FT N/O BCR 71FT N/O C/L TEMPLE AVE & 32FT E/O C/L VALINDA AVE	DG	4549
PUENTE (1990)	308.774	RDBM TAG 1FT N/O BCR 40FT W/O C/L SUNSET AVE & 68FT S/O C/L TEMPLE AVE	DG	4550
BASELINE (1990)	290.734	L&T IN CB 64FT E/O C/L 6TH AVE & 23FT S/O C/L DON JULIAN RD	DG	4576

QUAD-YEAR	ELEV	DESCRIPTION (INCLUDE QUAD AND YEAR IN DESCRIPTION)	BM NUMBER
BASELINE (1990)	287.669	L&T IN CB @ NW COR 6TH AVE & LOMITAS AVE 31FT N/O C/L LOMITAS AVE & 31FT W/O C/L 6TH AVE (CTR CB RET)	DG 4577
BASELINE (1990)	370.865	L&BRAD IN CB 28FT N/O C/L LOMITAS AVE & 28FT W/O C/L 3RD AVE (CTR CB RET)	DG 4578
BASELINE (1990)	339.604	L&T IN CB 47FT E/O C/L LOMITAS AVE & 42FT S/O C/L WORKMAN MILL RD (1FT E/O BCR)	DG 4579
BASELINE (1990)	303.619	DPW BM TAG IN E CB 66FT S/O C/L DON JULIAN RD & 42FT E/O C/L WORKMAN MILL RD (1FT N/O BCR)	DG 4580
BASELINE (1990)	292.562	L&T IN S CB 47FT W/O C/L SANTA MARIANA AVE & 44FT S/O VALLEY BLVD (3FT W/O BCR)	DG 4581
PUENTE (1990)	316.317	DPW BM TAG E CB SYRACUSE AVE 52FT S/O C/L RAMONA BLVD & 20FT E/O C/L SYRACUSE AVE (4FT S/O BCR)	DG 4593
BASELINE (1990)	301.563	L&BRAD IN CB RET @ NE COR GARVEY AVE & WESCOTT AVE 22FT N/O GARVEY AVE & 75FT E/O WESCOTT AVE (11FT W/O BCR)	DG 4594
BASELINE (1990)	321.214	DPW BM TAG W CB @ SW COR GARVEY AVE & WACO ST 44FT S & 20FT W/O C/L INT (1FT N/O BCR)	DG 4595
BASELINE (1990)	334.600	DPW BM TAG N CB @ NE COR FRANCISQUITO AVE & PUENTE AVE 30FT N & 76FT E/O C/L INT (1FT W/O BCR)	DG 4596
BASELINE (1990)	403.294	DPW BM TAG IN CB @ SE COR AZUSA AVE & TEMPLE AVE 30FT S & 75FT E/O C/L INT (1FT E/O BCR)	DG 4597
BASELINE (1990)	398.179	DPW BM TAG IN W CB @ NW COR AZUSA AVE & MAIN ST (TO THE WEST) 50FT W & 53FT N/O C/L INT (3FT S/O BCR)	DG 4598
BASELINE (1990)	319.847	L&PK IN CB @ NW COR HACIENDA BLVD & DON JULIAN RD 34FT N & 62FT W/O C/L INT (16FT E/O BCR)	DG 4634
BASELINE (1990)	343.368	DPW BM TAG S CB 4FT E/O BC OF CB 20FT S/O C/L OLD VALLEY BLVD & 420FT E/O C/L VALLEY BLVD OVERPASS (42FT S/O PP #215724)	DG 4635
BASELINE (1990)	372.358	DPW BM TAG IN CB @ NW COR VALLEY BLVD & WICKFORD AVE 42FT N & 55FT W/O C/L INT (1FT W/O BCR)	DG 4636
PUENTE (1990)	295.337	DPW BM TAG 1FT N/O BCR @ NE COR PROCTOR AVE & 7TH AVE 63FT N & 41FT E/O C/L INT	DG 4771



QUAD-YEAR	ELEV	DESCRIPTION (INCLUDE QUAD AND YEAR IN DESCRIPTION)	BM NUMBER
PUENTE (1990)	304.897	CITY OF INDUSTRY BR DISC 42FT N/O C/L VALLEY BLVD & 1FT E/O C/L PROD 9TH AVE MKD (NO V-11)	DG 4772
PUENTE (1990)	303.535	L&T N CB VALLEY BLVD ON C/L PROD 8TH AVE (42FT N/O C/L VALLEY BLVD)	DG 4773
PUENTE (1990)	298.124	CITY OF INDUSTRY BR DISC IN CONC HDWL 1FT N/O CB 30FT E/O C/L PROD 6TH AVE & 44FT N/O C/L VALLEY BLVD MKD (NO V-7)	DG 4774
PUENTE (1990)	300.202	CITY OF INDUSTRY BR DISC N CB 8FT W/O BCR @ NW COR ORANGE AVE & VALLEY BLVD 56FT W & 42FT N/O C/L INT MKD (NO V-6)	DG 4775
PUENTE (1990)	298.377	CITY OF INDUSTRY BR DISC IN CONC HDWL 1FT N/O CB 30FT E/O C/L PROD 5TH AVE & 42FT N/O C/L VALLEY BLVD MKD (NO V-5)	DG 4776
PUENTE (1990)	296.992	CITY OF INDUSTRY BR DISC IN CONC HDWL 1FT N/O CB 29FT E/O C/L PROD 4TH AVE & 42FT N/O C/L VALLEY BLVD MKD (NO V-4)	DG 4777
BASELINE (1990)	355.550	DPW BM TAG N CB 14FT E/O BCR 1FT W/O W WALL C B 20FT N/O C/L FRANCISQUITO AVE & 81FT E/O C/L HACIENDA BLVD	DG 4778
BASELINE (1990)	335.076	RCE TAG #5828 N CB 1FT E/O BCR @ NE COR OLD VALLEY BLVD & ALBERT ST 20FT N/O & 45FT E/O C/L INT	DG 4804
BASELINE (1990)	372.977	DPW BM TAG N CB 7FT E/O BCR & NE COR VALLEY BLVD & WICKFORD AVE 42FT N/O & 57FT E/O C/L INT W END C B	DG 4805